

WI-CPE110-KIT Hardware Version: V2

1.Packing Content

- WI-CPE110-KIT



Wireless Transmitter x 2



PoE Adapter x 2



Plastic Tie Cable x 2

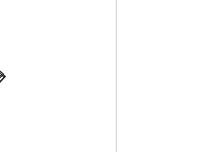

Ethernet Cable x 2



Quick Installation Guide x 1

2.Hardware Overview

- WI-CPE110-KIT

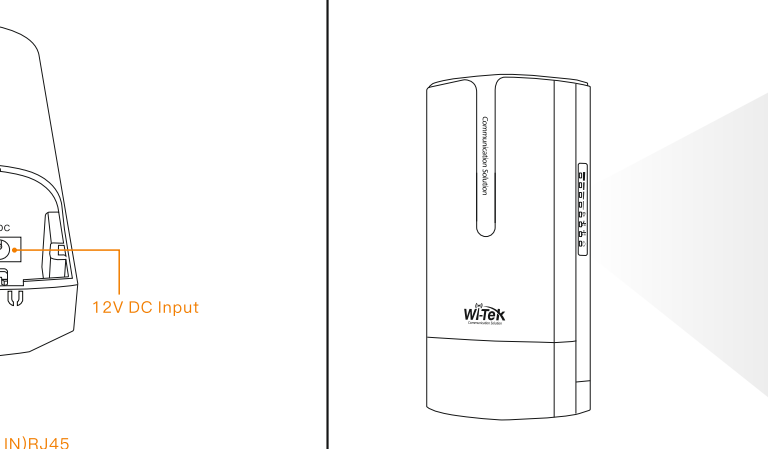

- Button

Button	Description
DIP Switch	H: Base station mode, supports wireless point-to-point and point-to-multipoint long-distance transmission. C: CPE mode, a receiving point for connecting a wireless base station.
Reset Button	Short press: Search for another wireless transmitter on a different mode (H/C status) and pair each other. The pair search will last for 120 seconds after short pressing the button. Long press over 5 seconds: Restore the factory default configuration.

- LED Indicator

LED Indicator	Status	Description
Power	Solid On	The system power supply is normal.
	Quick Blinking	Searching for another device and pairing.
	Off	The system power supply is abnormal.
WAN & LAN	Solid On	A link has been established on the interface.
	Off	No link is established on the interface.
Wi-Fi	Blinking	The wireless is activated.
Wireless Signal	Solid On	The wireless is paired successfully. The stronger the wireless signal, the more LED indicators are on.
	Off	The wireless is not paired or the wireless signal is too weak.

3. Installation

1. Insert ribbon at the backside bracket hole. Adjust it according to the pole size and installation position.



2. Install the device on the pole and tighten the ribbon.



3. Hold on the buckle to take down the device back cover. Insert the net cable into the network port, then fasten the back cover.

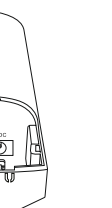

4. Application

Point to Point Connection for CCTV

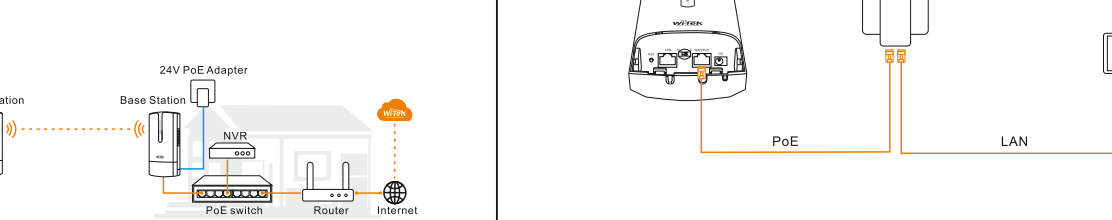

Point to Multi-Point Connection for CCTV

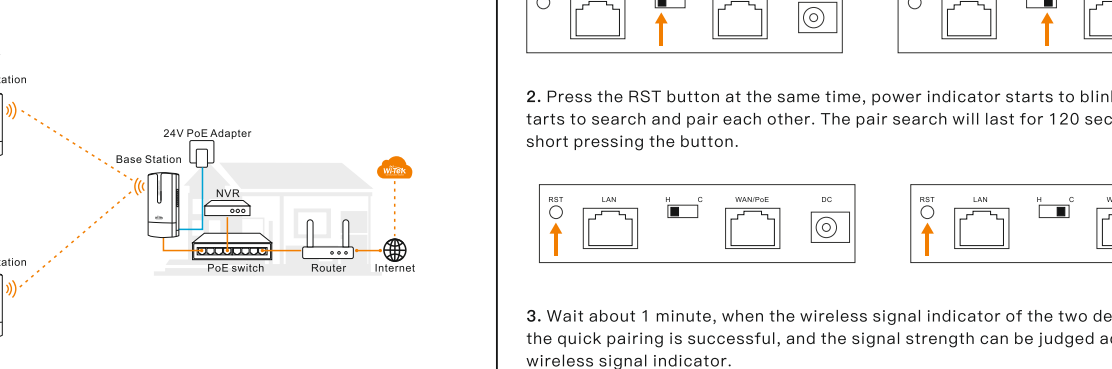

5. Quick Pairing

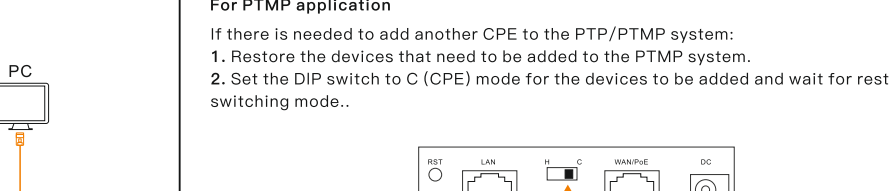

Quick Pairing

Note: it needs to restore the device to factory settings before quick pairing.

For PTP application

1. Set the DIP switch of the two devices to different modes (one to H and another to C), and wait for restart to switching mode.

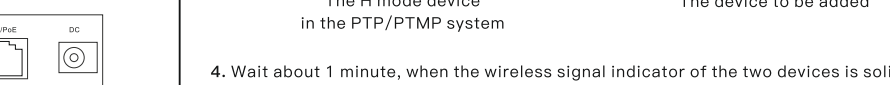

For PTP application

2. Press the RST button at the same time, power indicator starts to blink, the devices starts to search and pair each other. The pair search will last for 120 seconds after short pressing the button.



For PTP application

3. Wait about 1 minute, when the wireless signal indicator of the two devices is solid on, the quick pairing is successful, and the signal strength can be judged according to the wireless signal indicator.

6. Management

Management by WEB

- A) Set the device to Base Station Mode.

Step 1. Set PC network IP to 192.168.1.X (X: 2~50), subnet mask: 255.255.255.0, same network segment as device. Launch the browser and enter the login page default IP: 192.168.1.88 or 192.168.1.89, set the administrator password.

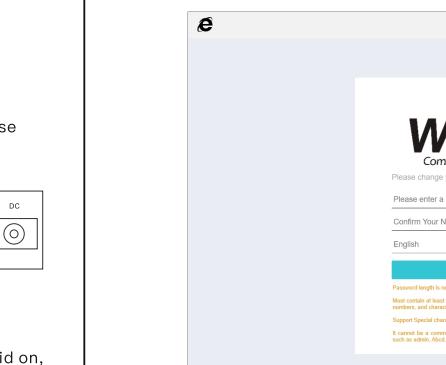

Step 2. Go to the "Wizard" page, select <Base Station Mode>, and click <Next>.

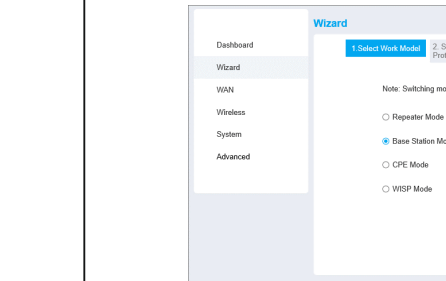

7. Cloud Management

Make sure your device has access to the Internet. Enter https://cloud2.wireless-tek.com in the browser and log in to the cloud, add a network, or select the existing network. Go to "Device > CPE", click <ADD DEVICE>, enter the device's SN and last six hexes of the device MAC address, and click <ADD>. Wait a moment, you can find it in the device list and view it in "Topology".

Add CPE

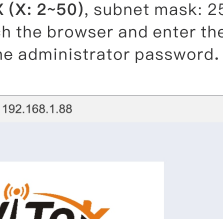

Step 7. Type in the base station wireless parameter and click <Next>.

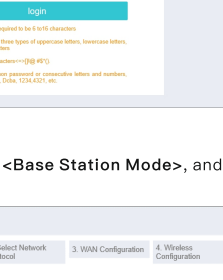

Step 8. Review the configurations and click <Confirm> to complete the wizard in the "confirm" page. The device will save the configuration and restart to switching mode.



Finish the above steps and wait for the device to restart. The PTP application configuration is complete when the signal strength indicators of both devices are on.

If you want to configure the PTMP application, repeat steps B) 5 ~ 8 for the other device after completing the PTP application.

8. Cloud Management

Make sure your device has access to the Internet. Enter https://cloud2.wireless-tek.com in the browser and log in to the cloud, add a network, or select the existing network. Go to "Device > CPE", click <ADD DEVICE>, enter the device's SN and last six hexes of the device MAC address, and click <ADD>. Wait a moment, you can find it in the device list and view it in "Topology".

Add CPE

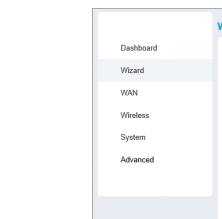

Step 7. Type in the base station wireless parameter and click <Next>.

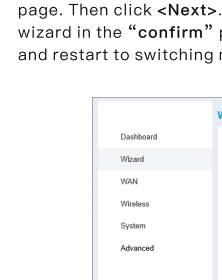

Step 8. Review the configurations and click <Confirm> to complete the wizard in the "confirm" page. The device will save the configuration and restart to switching mode.



Finish the above steps and wait for the device to restart. The PTP application configuration is complete when the signal strength indicators of both devices are on.

If you want to configure the PTMP application, repeat steps B) 5 ~ 8 for the other device after completing the PTP application.

9. Cloud Management

Make sure your device has access to the Internet. Enter https://cloud2.wireless-tek.com in the browser and log in to the cloud, add a network, or select the existing network. Go to "Device > CPE", click <ADD DEVICE>, enter the device's SN and last six hexes of the device MAC address, and click <ADD>. Wait a moment, you can find it in the device list and view it in "Topology".

Add CPE

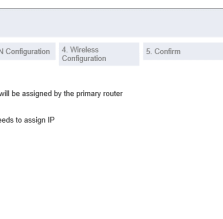

Step 7. Type in the base station wireless parameter and click <Next>.

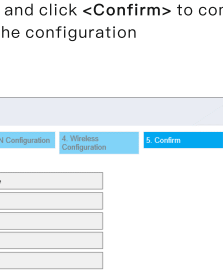

Step 8. Review the configurations and click <Confirm> to complete the wizard in the "confirm" page. The device will save the configuration and restart to switching mode.



Finish the above steps and wait for the device to restart. The PTP application configuration is complete when the signal strength indicators of both devices are on.

If you want to configure the PTMP application, repeat steps B) 5 ~ 8 for the other device after completing the PTP application.

10. Cloud Management

Make sure your device has access to the Internet. Enter https://cloud2.wireless-tek.com in the browser and log in to the cloud, add a network, or select the existing network. Go to "Device > CPE", click <ADD DEVICE>, enter the device's SN and last six hexes of the device MAC address, and click <ADD>. Wait a moment, you can find it in the device list and view it in "Topology".

Add CPE

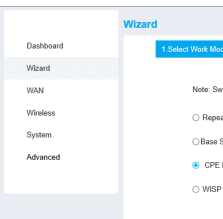

Step 7. Type in the base station wireless parameter and click <Next>.

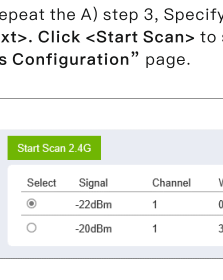

Step 8. Review the configurations and click <Confirm> to complete the wizard in the "confirm" page. The device will save the configuration and restart to switching mode.



Finish the above steps and wait for the device to restart. The PTP application configuration is complete when the signal strength indicators of both devices are on.

If you want to configure the PTMP application, repeat steps B) 5 ~ 8 for the other device after completing the PTP application.

11. Cloud Management

Make sure your device has access to the Internet. Enter https://cloud2.wireless-tek.com in the browser and log in to the cloud, add a network, or select the existing network. Go to "Device > CPE", click <ADD DEVICE>, enter the device's SN and last six hexes of the device MAC address, and click <ADD>. Wait a moment, you can find it in the device list and view it in "Topology".

Add CPE

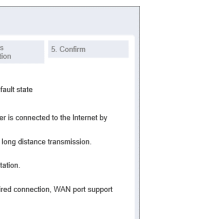

Step 7. Type in the base station wireless parameter and click <Next>.

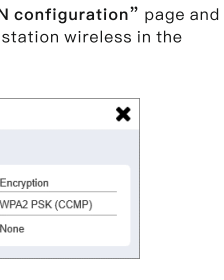

Step 8. Review the configurations and click <Confirm> to complete the wizard in the "confirm" page. The device will save the configuration and restart to switching mode.



Finish the above steps and wait for the device to restart. The PTP application configuration is complete when the signal strength indicators of both devices are on.

If you want to configure the PTMP application, repeat steps B) 5 ~ 8 for the other device after completing the PTP application.

12. Cloud Management

Make sure your device has access to the Internet. Enter https://cloud2.wireless-tek.com in the browser and log in to the cloud, add a network, or select the existing network. Go to "Device > CPE", click <ADD DEVICE>, enter the device's SN and last six hexes of the device MAC address, and click <ADD>. Wait a moment, you can find it in the device list and view it in "Topology".

Add CPE

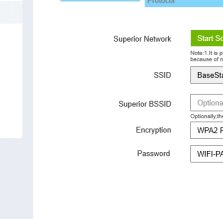

Step 7. Type in the base station wireless parameter and click <Next>.

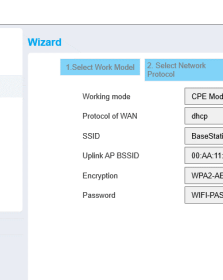

Step 8. Review the configurations and click <Confirm> to complete the wizard in the "confirm" page. The device will save the configuration and restart to switching mode.

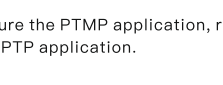

Finish the above steps and wait for the device to restart. The PTP application configuration is complete when the signal strength indicators of both devices are on.

If you want to configure the PTMP application, repeat steps B) 5 ~ 8 for the other device after completing the PTP application.

13. Cloud Management

Make sure your device has access to the Internet. Enter https://cloud2.wireless-tek.com in the browser and log in to the cloud, add a network, or select the existing network. Go to "Device > CPE", click <ADD DEVICE>, enter the device's SN and last six hexes of the device MAC address, and click <ADD>. Wait a moment, you can find it in the device list and view it in "Topology".

Add CPE

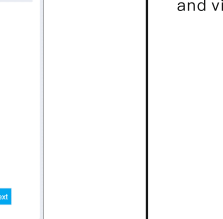

Step 7. Type in the base station wireless parameter and click <Next>.

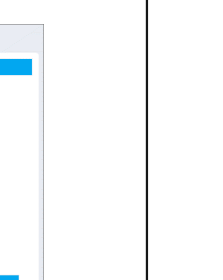

Step 8. Review the configurations and click <Confirm> to complete the wizard in the "confirm" page. The device will save the configuration and restart to switching mode.

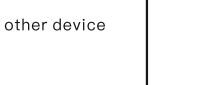

Finish the above steps and wait for the device to restart. The PTP application configuration is complete when the signal strength indicators of both devices are on.

If you want to configure the PTMP application, repeat steps B) 5 ~ 8 for the other device after completing the PTP application.

14. Cloud Management

Make sure your device has access to the Internet. Enter https://cloud2.wireless-tek.com in the browser and log in to the cloud, add a network, or select the existing network. Go to "Device > CPE", click <ADD DEVICE>, enter the device's SN and last six hexes of the device MAC address, and click <ADD>. Wait a moment, you can find it in the device list and view it in "Topology".

Add CPE

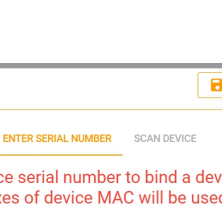

Step 7. Type in the base station wireless parameter and click <Next>.

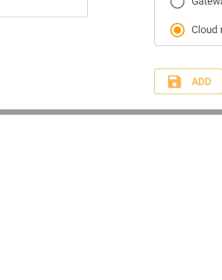

Step 8. Review the configurations and click <Confirm> to complete the wizard in the "confirm" page. The device will save the configuration and restart to switching mode.



Finish the above steps and wait for the device to restart. The PTP application configuration is complete when the signal strength indicators of both devices are on.

If you want to configure the PTMP application, repeat steps B) 5 ~ 8 for the other device after completing the PTP application.

15. Cloud Management

Make sure your device has access to the Internet. Enter https://cloud2.wireless-tek.com in the browser and log in to the cloud, add a network, or select the existing network. Go to "Device > CPE", click <ADD DEVICE>, enter the device's SN and last six hexes of the device MAC address, and click <ADD>. Wait a moment, you can find it in the device list and view it in "Topology".

Add CPE

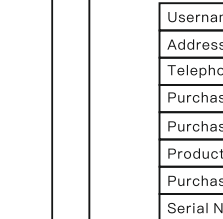

Step 7. Type in the base station wireless parameter and click <Next>.



Step 8. Review the configurations and click <Confirm> to complete the wizard in the "confirm" page. The device will save the configuration and restart to switching mode.



Finish the above steps and wait for the device to restart. The PTP application configuration is complete when the signal strength indicators of both devices are on.

If you want to configure the PTMP application, repeat steps B) 5 ~ 8 for the other device after completing the PTP application.

16. Cloud Management

Make sure your device has access to the Internet. Enter https://cloud2.wireless-tek.com in the browser and log in to the cloud, add a network, or select the existing network. Go to "Device > CPE", click <ADD DEVICE>, enter the device's SN and last six hexes of the device MAC address, and click <ADD>. Wait a moment, you can find it in the device list and view it in "Topology".

Add CPE



Step 7. Type in the base station wireless parameter and click <Next>.

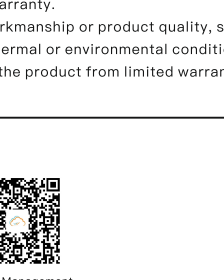

Step 8. Review the configurations and click <Confirm> to complete the wizard in the "confirm" page. The device will save the configuration and restart to switching mode.



Finish the above steps and wait for the device to restart. The PTP application configuration is complete when the signal strength indicators of both devices are on.

If you want to configure the PTMP application, repeat steps B) 5 ~ 8 for the other device after completing the PTP application.